



Baldslow Down, St. Leonards-On-Sea TN37 7NH

Offers in excess of £475,000



DETACHED FAMILY HOME set within a quiet and favoured Road on the CUSP OF WESTFIELD VILLAGE. The versatile accommodation here is arranged to include living room with a separate dining room and a LARGE EAT IN KITCHEN opening on to the PARK LIKE REAR GARDENS. There are THREE BEDROOMS sat on the first floor with a ground floor bedroom/study one of which enjoys a shower EN-SUITE, there is also a family bathroom. From its elevated position there are STUNNING COUNTRYSIDE VIEWS and to the front of the property is OFF ROAD PARKING for numerous cars and an INTEGRAL GARAGE. The rear garden is a particular feature here and has been beautifully maintained and backs on to neighbouring woodland giving a real sense of PRIVACY AND SECLUSION.

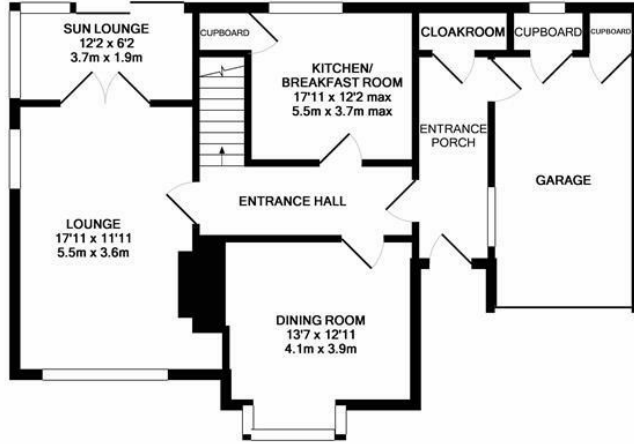

GROUND FLOOR
APPROX. FLOOR
AREA 947 SQ.FT.
(88.0 SQ.M.)



1ST FLOOR
APPROX. FLOOR
AREA 688 SQ.FT.
(63.9 SQ.M.)

TOTAL APPROX. FLOOR AREA 1635 SQ.FT. (151.9 SQ.M.)

Whilst every attempt has been made to ensure the accuracy of the floor plan contained here, measurements of doors, windows, rooms and any other items are approximate and no responsibility is taken for any error, omission, or mis-statement. This plan is for illustrative purposes only and should be used as such by any prospective purchaser. The services, systems and appliances shown have not been tested and no guarantee as to their operability or efficiency can be given.

Made with Metropix 62019

